

2026 SPOKANE COUNTY

CAREER

Expo



WELCOME! We're excited to have you here exploring your next career move. This year's event is bigger and better, thanks to your feedback! Enjoy on-site amenities like interpreters (wearing white vests), a child activity room by Vanessa Behan, computer lab by Spokane County Library District, mini-workshops, hands-on demos, and concessions for purchase. **Need help? Look for staff in WorkSource or Talent Solutions shirts.**



INTERACTIVE DISPLAY AREA

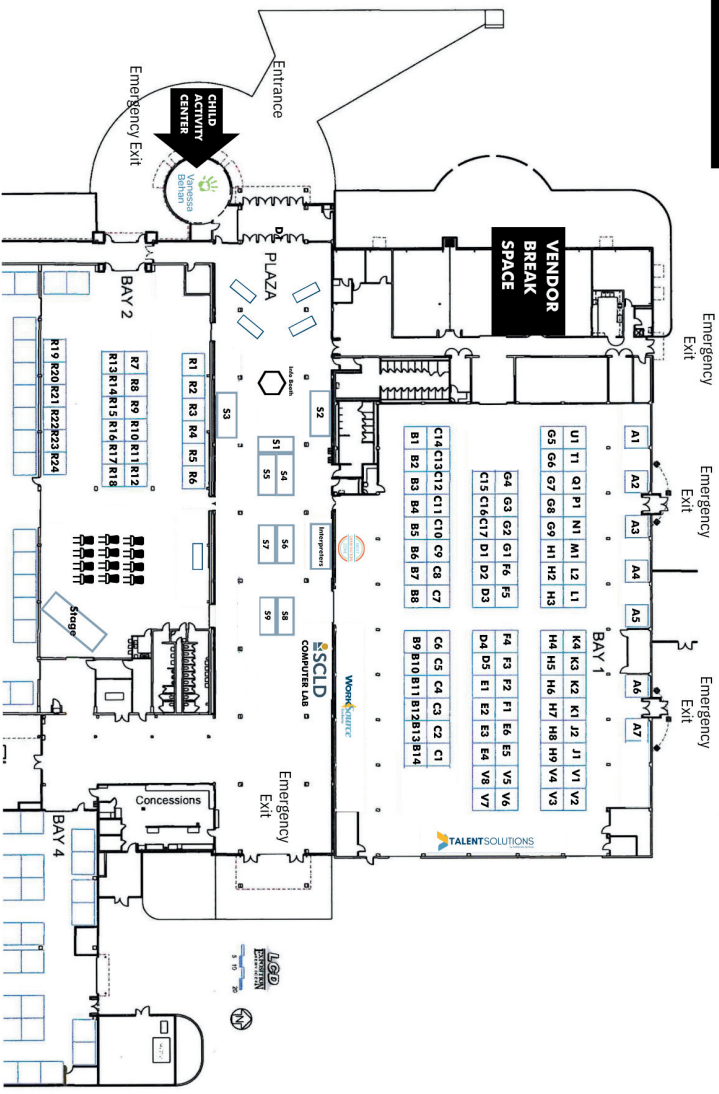



S P O N S O R S

S1	NONSTOP LOCAL KHQ
S2	WAGSTAFF, INC.
S3	COLUMBIA BANK
S4	iHEART MEDIA
S5	SOLSTICE, INC.
S6	CHAS HEALTH
S7	MANPOWER
S8	GOODWILL INDUSTRIES OF THE INLAND NW

TRAINING PROVIDERS

EDUCATION

A1

PAUL MITCHELL THE SCHOOL RICHLAND

A2

CURLEW JOB CORPS CCC

A3

SPOKANE COLLEGES

TRANSPORTATION AND WAREHOUSING

A4

DRIVE509

A5

SPOKANE CDL SCHOOL

CONSTRUCTION AND MANUFACTURING

A6

MACHINISTS INSTITUTE

A7

CITC

RESOURCE PROVIDERS

R1	ARTISANS
R2	ATWORK!
R3	KSPS-PBS-CAREER EXPLORE NORTHWEST
R4	COMMUNITIES IN SCHOOLS OF NORTHEAST WASHINGTON
R5	COMMUNITY-MINDED ENTERPRISES
R6	SPOKANE TREATMENT AND RECOVERY SERVICES
R7	BECU
R8	SPOKANE SLAVIC ASSOCIATION
R9	JOBBY CRM
R10	GOODWILL INDUSTRIES OF THE INLAND NORTHWEST
R11	SPOKANE INDEPENDENT METRO BUSINESS ALLIANCE (SIMBA)
R12	DEPARTMENT OF SERVICES FOR THE BLIND
R13	DSHS - DIVISION OF VOCATIONAL REHABILITATION
R14	SPOKANE COMMUNITY COLLEGE
R15	WORLD RELIEF SPOKANE
R16	COMPASS CAREER SOLUTIONS

RESOURCE PROVIDERS

R17

GRAND CANYON UNIVERSITY

R18

A WOMAN'S WORTH

R19

VETS GARAGE

R20

CAREER PATH SERVICES

R21

HEALTH AND JUSTICE RECOVERY ALLIANCE

R22

YOU ARE SEEN

R23

GLOBAL NEIGHBORHOOD

R24

MORNING STAR

**G O V E R N M E N T A N D
N O N - P R O F I T**

B1	CITY OF SPOKANE
B2	SPOKANE FIRE DEPARTMENT
B3	SPOKANE COUNTY
B4	DEPARTMENT OF WAR - DEPT. OF DEFENSE
B5	DSHS BHHA EASTERN STATE HOSPITAL
B6	YMCA OF THE INLAND NORTHWEST
B7	UNITED STATES AIR FORCE - SUPPORT SQUADRON
B8	THE SALVATION ARMY
S8	GOODWILL INDUSTRIES OF THE INLAND NW
B9	CATHOLIC CHARITIES EASTERN WASHINGTON
B10	SPOKANE COUNTY LIBRARY DISTRICT
B11	PEND OREILLE COUNTY
B12	WA STATE DEPT. OF CORRECTIONS
B13	DOI - BUREAU OF INDIAN AFFAIRS
B14	TESSERA

HEALTHCARE AND SOCIAL SERVICES

S6	CHAS HEALTH
C1	INLAND IMAGING
C2	COMMUNITY VISIONS INC.
C3	ALTERNATIVE NURSING SERVICES
C4	PIONEER HUMAN SERVICES
C5	LOVING NEIGHBOR HOME CARE LLC
C6	CARE TO STAY HOME
C7	CLARVIDA
C8	PNW HELPING HANDS
C9	ALL WAYS CARING HOME CARE
C10	ASSISTED RESIDENTIAL SERVICES INC.
C11	LEAPS AND BEYOND INC.
C12	ANGEL SENIOR CARE
C13	MULTICARE HEALTH SYSTEM
C14	EXCEL SUPPORTED LIVING INC. AND AIM COMMUNITY SERVICES
C15	DEVELOPMENTAL DISABILITIES COMMUNITY SERVICES

HEALTHCARE AND SOCIAL SERVICES

C16 MADDIE'S PLACE

C17 RIGHT AT HOME

HOSPITALITY

D1 GOZZER RANCH GOLF AND LAKE CLUB

D2 ENVIRONMENT CONTROL

D3 COMPASS - LEVY RESTAURANTS

D4 DAVENPORT HOTELS

D5 ALPINE CLEANING COMPANY

EMPLOYMENT SERVICES

E1 EXPRESS EMPLOYMENT PROFESSIONALS

E2 ABILITY EMPLOYMENT SERVICES

S7 MANPOWER

E3 PROVISIONAL SERVICES

E4 HUMANIX

E5 AEROTEK

E6 ATLAS STAFFING

CONSTRUCTION AND TRADES

F1	ASSOCIATED BUILDERS AND CONTRACTORS IPC
F2	NORTHWEST LABORERS APPRENTICESHIP TRAINING
F3	MAINSTREAM AND BULLDOG ROOTER
F4	RENEWAL BY ANDERSON
F5	HANDYMAN CONNECTION OF SPOKANE
F6	DIVISION 1 PLUMBING

TRANSPORTATION & WAREHOUSING

G1	URM STORES INC.
G2	HOLIDAY MOTOR COACH
G3	TDR LOGISTICS LLC
G4	SPOKANE PRODUCE, INC
G5	SPOKANE TRANSIT AUTHORITY
G6	CATERPILLAR
G7	WALKER FURNITURE
G8	NORLIFT
G9	LTR AGRICULTURE

M A N U F A C T U R I N G

H1 WILBUR PRECAST INC.

H2 COLLINS AEROSPACE

H3 JETSEAL

H4 MULTIFAB

S5 SOLSTICE

S2 WAGSTAFF

H5 FRANZ FAMILY BAKERY

H6 TRAVIS PATTERN AND FOUNDRY

H7 JUBILANT HOLLISTERSTIER

H8 INTERMOUNTAIN MACHINE

H9 HAAKON INDUSTRIES

A R T S , E N T E R T A I N M E N T , A N D R E C R E A T I O N

J1 NORTHERN QUEST RESORT AND CASINO

J2 SPOKANE PUBLIC FACILITIES DISTRICT

R E T A I L T R A D E

U1 BATTERIES PLUS

E D U C A T I O N

K1	SPOKANE PUBLIC SCHOOLS
K2	EASTERN WASHINGTON UNIVERSITY
K3	MEAD SCHOOL DISTRICT
K4	COMMUNITY COLLEGES OF SPOKANE

F I N A N C E A N D I N S U R A N C E

S3	COLUMBIA BANK
L1	NUMERICA CREDIT UNION
L2	STCU

V E T E R I N A R Y S E R V I C E S

M1	PET EMERGENCY CLINIC
----	----------------------

S E C U R I T Y I N D U S T R Y

N1	KODIAK SECURITY SERVICES, INC
----	-------------------------------

U T I L I T I E S

P1	AVISTA UTILITIES
----	------------------

A U T O M O T I V E

Q1	KNUDTSEN AUTO GROUP
----	---------------------

A V I A T I O N

T1	AERO-FLITE, INC.
----	------------------

The background features a collage of images: a city skyline with a tall tower, a suspension bridge, a river with autumn trees, and a clock tower. The text is overlaid on a semi-transparent white and yellow graphic.

C O N S T R U C T I O N

V1 MW WINKLER CO.

V4 MASTEC

G O V . A N D N O N - P R O F I T

V2 COLVILLE CONFEDERATED TRIBES

V7 U.S. NAVY RECRUITING

V8 U.S. ARMY

M A N U F A C T U R I N G

V3 ANDRITZ HYDRO CORP.

R E T A I L T R A D E

V5 NAPA AUTO PARTS

V6 ENTERPRISE MOBILITY

THANK YOU

TO OUR SPONSORS!



MEDIA:



EVENT:



PLATINUM:



GOLD:



SILVER:

